

Моечные машины для стекла WD

Технические характеристики

По вопросам продаж и поддержки обращайтесь:

Алматы (727)345-47-04
Ангарск (3955)60-70-56
Архангельск (8182)63-90-72
Астрахань (8512)99-46-04
Барнаул (3852)73-04-60
Белгород (4722)40-23-64
Благовещенск (4162)22-76-07
Брянск (4832)59-03-52
Владивосток (423)249-28-31
Владикавказ (8672)28-90-48
Владимир (4922)49-43-18
Волгоград (844)278-03-48
Вологда (8172)26-41-59
Воронеж (473)204-51-73
Екатеринбург (343)384-55-89

Иваново (4932)77-34-06
Ижевск (3412)26-03-58
Иркутск (395)279-98-46
Казань (843)206-01-48
Калининград (4012)72-03-81
Калуга (4842)92-23-67
Кемерово (3842)65-04-62
Киров (8332)68-02-04
Коломна (4966)23-41-49
Кострома (4942)77-07-48
Краснодар (861)203-40-90
Красноярск (391)204-63-61
Курск (4712)77-13-04
Курган (3522)50-90-47
Липецк (4742)52-20-81

Магнитогорск (3519)55-03-13
Москва (495)268-04-70
Мурманск (8152)59-64-93
Набережные Челны (8552)20-53-41
Нижний Новгород (831)429-08-12
Новокузнецк (3843)20-46-81
Ноябрьск (3496)41-32-12
Новосибирск (383)227-86-73
Омск (3812)21-46-40
Орел (4862)44-53-42
Оренбург (3532)37-68-04
Пенза (8412)22-31-16
Петрозаводск (8142)55-98-37
Псков (8112)59-10-37
Пермь (342)205-81-47

Ростов-на-Дону (863)308-18-15
Рязань (4912)46-61-64
Самара (846)206-03-16
Санкт-Петербург (812)309-46-40
Саратов (845)249-38-78
Севастополь (8692)22-31-93
Саранск (8342)22-96-24
Симферополь (3652)67-13-56
Смоленск (4812)29-41-54
Сочи (862)225-72-31
Ставрополь (8652)20-65-13
Сургут (3462)77-98-35
Сыктывкар (8212)25-95-17
Тамбов (4752)50-40-97
Тверь (4822)63-31-35

Тольятти (8482)63-91-07
Томск (3822)98-41-53
Тула (4872)33-79-87
Тюмень (3452)66-21-18
Ульяновск (8422)24-23-59
Улан-Удэ (3012)59-97-51
Уфа (347)229-48-12
Хабаровск (4212)92-98-04
Чебоксары (8352)28-53-07
Челябинск (351)202-03-61
Череповец (8202)49-02-64
Чита (3022)38-34-83
Якутск (4112)23-90-97
Ярославль (4852)69-52-93

Россия +7(495)268-04-70

Казахстан +7(727)345-47-04

Беларусь +(375)257-127-884

Узбекистан +998(71)205-18-59

Киргизия +996(312)96-26-47

эл.почта: wkd@nt-rt.ru || сайт: <https://wexiodisk.nt-rt.ru/>



WD-4S BASIC / GLASS

UNDERCOUNTER DISHWASHER

FEATURES

- The WD-4S can wash up to 50 baskets per hour. This amounts to 1,000 glasses, 900 plates or 450 trays - hour after hour after hour.
- The clean design means that the washing chamber is larger and can even accommodate trays up to a size of 530 x 330 mm and 1/1 canteens with accessories.
- A simple push of a button allows you to easily change the water so you can switch between washing soiled plates and washing glasses and trays. The two functions in the same machine save both space and time.
- The low noise levels when the machine is in operation results in a good working environment.
- The door can be placed in a space-saving hygienic position, which prevents the growth of bacteria when the machine is not in use.
- The stainless steel wash arms have individually positioned nozzles. This allows coverage and cleaning of every millimetre of the dishware.
- An inbuilt drain pump ensures that all of the water is emptied regardless of the machine's position.
- Automatic control of the water temperature and quantity, as well as automatic cleaning, ensures a high standard of hygiene.
- Inbuilt dosing for both detergent and drying agents simplifies operation. No need for bulky dosing equipment next to the machine.
- Back flow protection prevents the back-flow of dirty water into the mains water system.



OPTIONS

- ECO-FLOW condensing unit with heat recovery by the exhausted steam. (Cold water connection is required) 6,9 kW booster heater is recommended.
- Built-in Softener treats hard water for better washing and rinsing results by reducing the lime content. Can not be combined with a condensation unit, active filter, or marine version. The machine must be equipped with a break tank.

- Booster heater 6,9 kW for cold water connection. Connection power 7,65 kW, 16A, only 3-fase connection. Capacity approx 35 baskets/hour.
- Active filter for continuous cleaning of water in wash tank.

EXTRA EQUIPMENT

- Bottom frame with guide rails for 3 baskets (201.0556)
- Bottom frame with guide rails for 3 baskets, lockable cabinet for detergent and drying agent for (201.0557)

- Integrated under the bench set, on right side (201.0550H)
- Integrated under the bench set, on left side (201.0550V)
- Splash plate on roof (201.0581)
- Glass basket (201.0558)

TECHNICAL DATA BASIC & GLASS MODEL	WD-4S
Wash pump (kW)	0.75
Booster heater (kW) (400V / 230V)	4.2/2.8
Tank heater (kW)	1.4
Drain pump (kW)	0.04
Booster pump (kW) *	0.37
Tank volume (litres)	20
Heat recovery fan (kW) **	0.01
Weight, machine in operation (kg)	85
Enclosure class (IP)	45

* Only in combination with breaktank
 ** Option on some markets

CAPACITY AND OPERATING DATA	WD-4S
Capacity, maximum number of baskets per hour	50**
Basket size (mm)	500x500
Total wash time BASIC programme 1 (min.) **	1.2
Total wash time BASIC programme 2 (min.) **	2.4
Total wash time BASIC programme 3 (min.) **	4.2
Total wash time GLASS programme 1 (min.) **	1.2
Total wash time GLASS programme 2 (min.) **	1.2
Total wash time GLASS programme 3 (min.) **	2.2
Water consumption rinse/programme (litres)	2.4
Sound level (dB(A))	61
Maximum surface temperature at a room temperature of 20°C	35

* Hot water connection 50 - 65 °C. With cold water connection or condensing unit the capacity is lowered.
 ** Factory setting. The wash time is adjustable.

CONNECTION, MACHINE	WD-4S
Total connected power (kW) (400V 3N~) *	4.95/7.65*
Total connected power (kW) (230V 1N~)	3.55
Main fuse (400V 3N~ (A)) **	10/16**
Main fuse (230V 3N~ (A))	16
Connection cable, area 400V 3N~ (L1-L3, N, PE) Cu (mm2) ***	2.5

* Cold water connection
 ** Other voltage on request
 *** 2 meter cable is included

WATER, DRAIN AND VENTILATION CONNECTIONS	WD-4S
Water quality, hardness (°dH)	2-7
Hot water connection (50- 65 °C) (external thread) as standard	R ¾"
Cold water connection (5-12 °C) (external thread) * when using ECO-FLOW	R ¾"
Drain connection, hose 2 meter, of which 1.3 meters outside the machine (ø mm)	22
Water capacity, pressure (kPa)	20
Water capacity, flow (litres/min)	5
Floor drain (litres/sec.)	1
Heat load to the room (total, sensible, latent) (kW)	1.7 / 1.2 / 0.5
For machines with the option ECO-FLOW: heat load to the room (total, sensible, latent) (kW)	0.9 / 0.6 / 0.3

* Option on some markets

SIZE AND WEIGHT FOR TRANSPORTATION	WD-4S
Size (LxWxH) (mm) incl. packaging	700x760x1000
Weight of machine (kg), including packaging	85

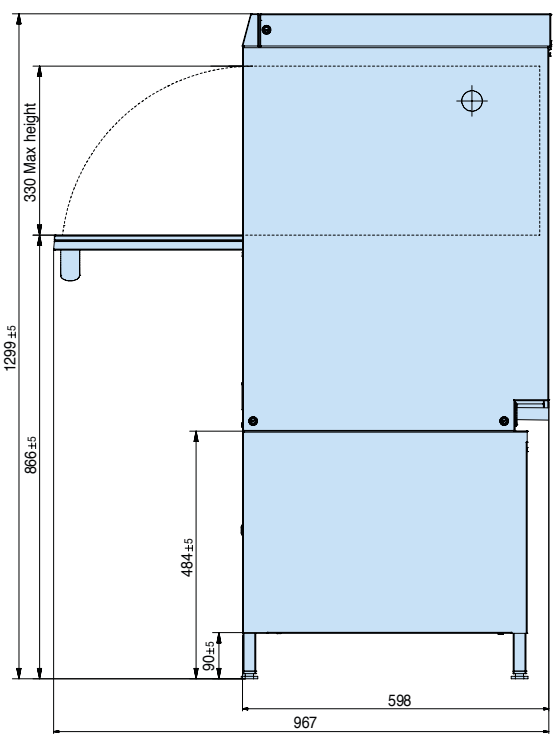
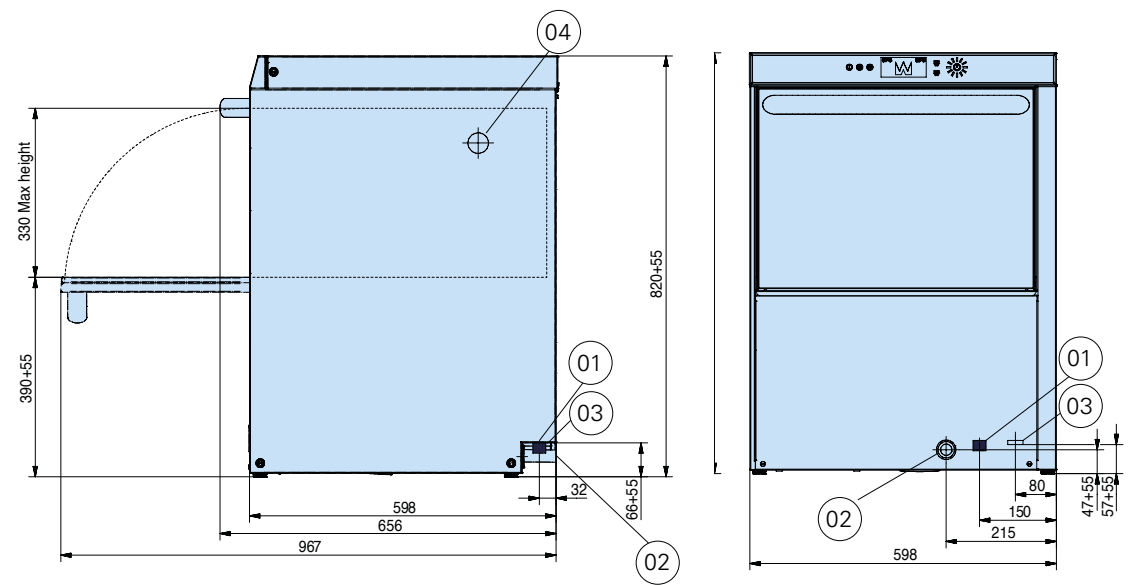

- 01. Water connection, external thread, R3/4".
- 02. Drain connection, PP pipe, Ø 22mm, length 2m
- 03. Electrical connection cable, length 2m
- 04. Non-return valve

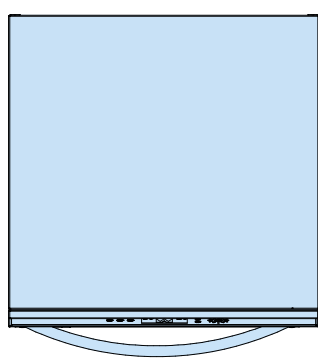



WD-4S

CABINET FLOOR STAND

FEATURES

- Cabinet floor stand is adapted for undercounter dishwasher WD-4S.
- Ergonomic - the dishwasher gets a good working height placed on the stand.
- Made of stainless steel.
- With lockable door or open sides.
- Easy storage of detergent or washing baskets.



SIZE AND WEIGHT FOR TRANSPORTATION

WD-4S CABINET FLOOR STAND

Size (LxWxH) (cm) incl. packaging

58x51x63

Weight (kg), including packaging

16

Weight (kg), including packaging (with lockable door)

22

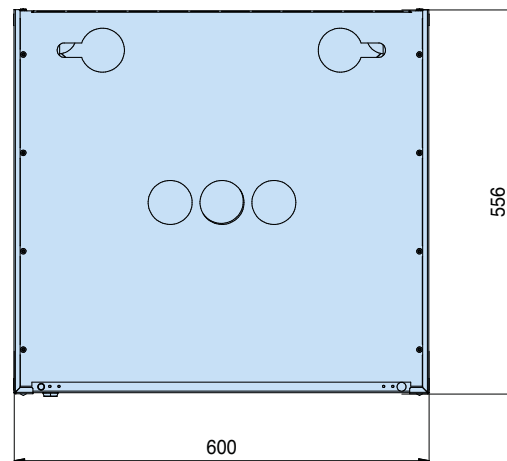
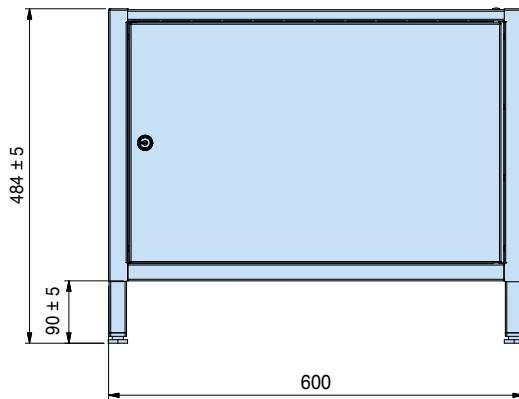

We reserve the right to make changes to the technical data.



WD-6 GLASS

HOOD TYPE DISHWASHER

FEATURES

- The unique *Glasstilt* prevents water from accumulating on the base of the glass. Manual polishing of glass is minimized
- Robust and reliable design in stainless steel with components that guarantee a durable and reliable operation for many years
- The machine has an energy saving heat and sound insulating double-skinned hood.
- A good working environment with the unique hood concept
- High levels of hygiene with an automatic cleaning programme and guaranteed rinse temperature by thermal stop system
- Self-drained wash pump
- Break tank with booster pump
- Large deep tank to protect against foaming
- Easy servicing - the machine is serviced from the front
- Hygiene control – control system with integrated HACCP
- Excellent wash results – with selfdraining washing arms
- Powerful washing pressure with anti-blocking nozzles
- Individual adjustable wash- and rinse times as well as temperatures for each programme
- Inbuilt dosing pump for fine dosage of rinse aid
- Automatic cleaning program
- Water connection x 2 (RO)



OPTIONS

- Automatic hood
- Autostart for automatic hood
- 230V/3/50Hz
- Drain pump
- Detergent pump for liquid detergent
- ECO-FLOW condensing unit with heat recovery by the exhausted steam. (cold water connection is required)
- WEB Tool - For external HACCP documentation

EXTRA EQUIPMENT

- Steam hood with suction connection
- Shelf for chemical storage
- Sideboard (560 x 560 mm)

TECHNICAL DATA	WD-6 GLASS
Wash pump (kW)	0.9
Booster heater (kW)	12
Heater tank (kW)	1.8
Tank volume (litres)	50
Weight, machine in operation (kg)	160
Degree of protection (IP)	45

CAPACITY AND OPERATION DATA	WD-6 GLASS
Total time/wash program 1 (min)	1.2**
Total time/wash program 2 (min)	1.2**
Total time/wash program 3 (min)	2.2**
Capacity, max (baskets/h)	50
Water consumption rinse/program (litres)	2.5-4***
Energy consumption (kWh of connected power)	70-90%
Sound level* (dB(A))	60

* Measured 1 metre from the machine.

** Factory setting. The wash time is adjustable.

*** The water consumption depends on local conditions. An exact adjustment is made during installation.

CONNECTION, MACHINE	WD-6 GLASS
Total connected power (kW)	12.9
Main fuse 400V 3N~ (A)	25
Max connection area 400V 3N~(L1-L3, N, PE) Cu (mm2)*	2.5

* Cabel 2.5m H07RN-F included.

CONNECTION WATER, DRAIN AND VENTILATION	WD-6 GLASS
Water quality, hardness (°dH)	2-7
Water connection 5-65°C (external thread)	R 1/2"
Drain connection, PP pipe (ø mm)	50
Water capacity, pressure (kPa)	180
Water capacity, flow (litres/min)	18
Water capacity hood lift, pressure (kPa)	180
Floor drain, capacity (litres/sec)	3
Heat load to the room (total, sensible, latent) (kW)	2.3 / 1.7 / 0.6
For machines with the option ECO-FLOW: heat load to the room (total, sensible, latent) (kW)	1.2 / 0.9 / 0.3

SIZE AND WEIGHT FOR TRANSPORTATION	WD-6 GLASS
Size LxWxH (mm) *	765x710x1560
Weight (kg) *	115

* Packaging included.

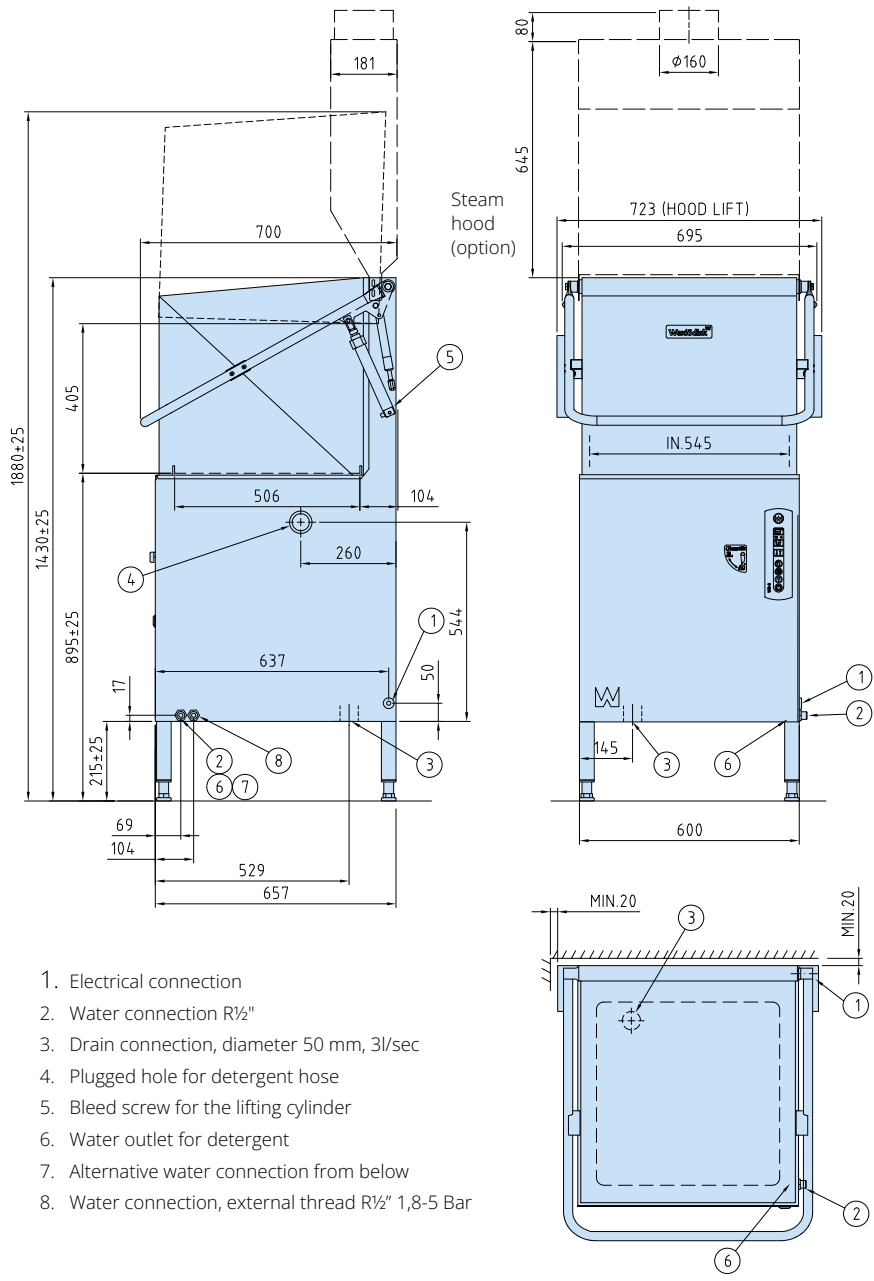

1. Electrical connection
2. Water connection R1/2"
3. Drain connection, diameter 50 mm, 3l/sec
4. Plugged hole for detergent hose
5. Bleed screw for the lifting cylinder
6. Water outlet for detergent
7. Alternative water connection from below
8. Water connection, external thread R1/2" 1,8-5 Bar

WD-6 GLASS with **ECO-FLOW** condensing unit and heat exchanger

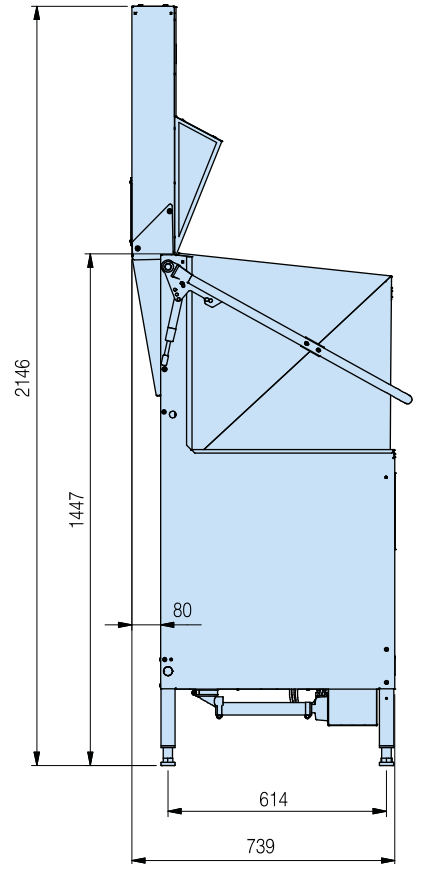



WD-6 DUPLUS GLASS

HOOD TYPE DISHWASHER

FEATURES

- The unique Glasstilt prevents water from accumulating on the base of the glass. Manual polishing of glass is minimized
- Double final rinse with DUPLUS technology – Improved rinsing results using less fresh water
- High efficiency with low operating costs – DUPLUS technology reduces the consumption of fresh water, chemicals and electricity
- Robust and reliable design in stainless steel with components that guarantee a durable and reliable operation for many years
- The machine has an energy saving heat and sound insulating double-skinned hood
- A good working environment with the unique hood concept
- Self-drained wash pump
- High levels of hygiene with an automatic cleaning programme and guaranteed rinse temperature by thermal stop system
- Large deep tank to protect against foaming
- Easy servicing - the machine is serviced from the front
- Hygiene control – control system with integrated HACCP
- Excellent wash results – with selfdraining washing arms
- Powerful washing pressure with anti-blocking nozzles
- Individual adjustable wash- and rinse times as well as temperatures for each programme
- Inbuilt dosing pump for fine dosage of rinse aid
- Break tank with booster pump
- Automatic cleaning program
- Water connection x 2 (RO)



OPTIONS

- Automatic hood
- Autostart for automatic hood
- 230V/3/50Hz
- Drain pump
- Detergent pump for liquid detergent
- ECO-FLOW condensing unit with heat recovery by the exhausted steam. (cold water connection is required)
- WEB Tool - For external HACCP documentation

EXTRA EQUIPMENT

- Steam hood with suction connection
- Shelf for chemical storage
- Sideboard (560 x 560 mm)

TECHNICAL DATA	WD-6 DUPLUS GLASS
Wash pump (kW)	0.9
Pump, recirculated rinse (kW)	0.58
Pump, final rinse (kW)	0.58
Booster heater (kW)	9
Tank heater (kW)	5.4
Tank volume, chemical wash tank (liter)	45
Tank volume, recirculated rinse (liter)	5.5
Weight, machine in operation (kg)	185
Enclosure class (IP)	45

CAPACITY AND OPERATING DATA	WD-6 DUPLUS GLASS
Total washing time P1 (min) *	1.2
Total washing time P2 (min) *	1.8
Total washing time P3 (min) *	3.3
Max. capacity, baskets/hour (no.)	50
Water consumption rinsing/programme (liter)	1.0 - 1.5
Energy consumption (% of connected power)	30 - 50%
Sound level (dB(A))**	63

* Factory setting. The washing time can be adjusted.

** Measured 1 metre from the side of the machine.

CONNECTION, MACHINE	WD-6 DUPLUS GLASS
Total connected power (kW)	9.9
Main fuse 400 3N- (A) *	16
Max. connection area 400-415V 3N~ (L1-L3,N,PE) Cu (mm ²) **	2.5

* Other voltage on request.

** Cable 3 m H07RN-F is included.

WATER, DRAIN AND VENTILATION CONNECTIONS	WD-6 DUPLUS GLASS
Water quality, hardness (°dH)	2 - 7
Water connection 5-65°C (external thread)*	R 1/2"
Drain connection, PP pipe (ø mm.)	50
Water capacity, min/max pressure (kPa)	20
Water capacity, flow (litres/min)	5
Floor drain, capacity (litres/sec)	3
Heat load to the room (total, sensible, latent) (kW)	1.7 / 1.2 / 0.5
For machines with the option ECO-FLOW: heat load to the room (total, sensible, latent) (kW)	0.9 / 0.6 / 0.3

* When using cold water <55°C the filling time is longer.

SIZE AND WEIGHT FOR TRANSPORTATION	WD-6 DUPLUS GLASS
Size, LxWxH (mm.)*	765x710x1560
Weight (kg)*	140

* Packaging included

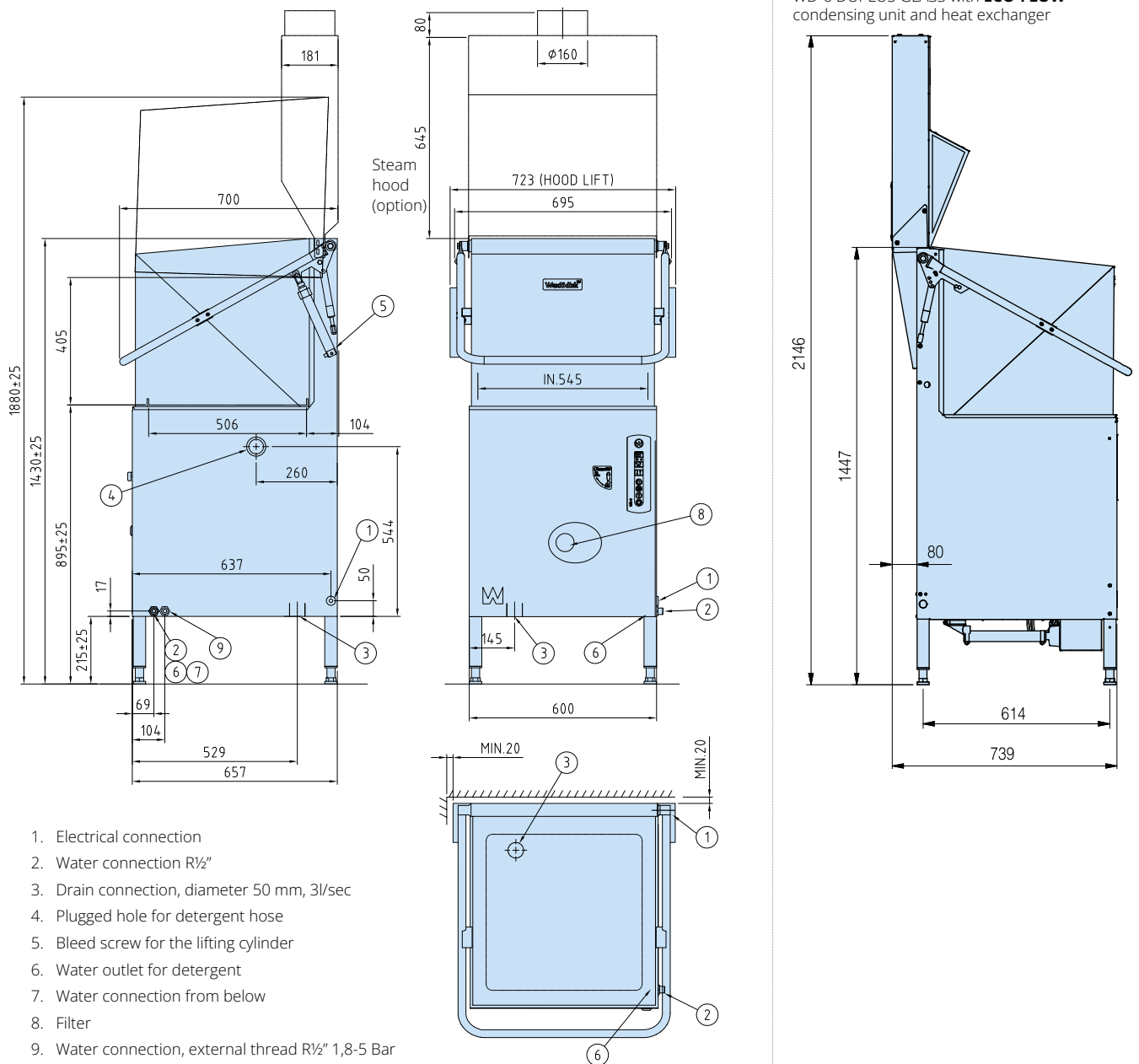



WD-7 GLASS

HOOD TYPE DISHWASHER

FEATURES

- The unique glasstilt prevents water from accumulating on the base of the glass. Manual polishing of glass is minimized
- Unique and flexible washing system. The machines water pressure can be reset quickly and easily between normal and heavily soiled settings
- Robust and reliable design in stainless steel with components that guarantee a durable and reliable operation for many years
- Thanks to the adjustable water pressure you can easily switch between normal and heavily soiled loads
- The machine has an energy saving heat and sound insulating double-skinned hood
- A good working environment with the unique hood concept
- High levels of hygiene with an automatic cleaning programme and guaranteed rinse temperature by thermal stop system
- Self-drained wash pump
- Large deep tank to protect against foaming
- Break tank with booster pump
- Easy servicing - the machine is serviced from the front
- Hygiene control – control system with integrated HACCP
- Excellent wash results – with selfdraining washing arms
- Powerful washing pressure with anti-blocking nozzles
- Individual adjustable wash- and rinse times as well as temperatures for each programme
- Inbuilt dosing pump for fine dosage of rinse aid
- Automatic cleaning program
- Water connection x 2 (RO)



OPTIONS

- Automatic hood
- Autostart for automatic hood
- 230V/3/50Hz
- Drain pump
- Detergent pump for liquid detergent
- ECO-FLOW condensing unit with heat recovery by the exhausted steam. (cold water connection is required)
- WEB Tool - For external HACCP documentation

EXTRA EQUIPMENT

- Steam hood with suction connection
- Shelf for chemical storage
- Sideboard (560 x 560 mm)

TECHNICAL DATA	WD-7 GLASS
Wash pump (kW)	1.1
Booster heater (kW)	12
Tank heater (kW)	1.8
Tank volume (litres)	50
Weight, machine in operation (kg)	170
Enclosure class (IP)	45

CAPACITY AND OPERATING DATA	WD-7 GLASS
Total washing time P1 (min)	1.2**
Total washing time P2 (min)	1.2**
Total washing time P3 (min)	2.2**
Max. capacity, baskets/hour (no.)	50
Water consumption rinsing/programme (litres)	2.5-4***
Energy consumption (% of connected power)	70-90%
Sound level (dB(A))*	62/60

* Measured 1 metre from the side of the machine.

** Factory setting. The washing time can be adjusted.

*** The water consumption depends on local conditions. An exact adjustment is made during installation.

CONNECTION, MACHINE	WD-7 GLASS
Total connected power (kW)	13.1
Main fuse 400V 3N~ (A)	25
Max. connection area 400-415V 3N~ (L1-L3,N,PE) Cu (mm2) *	2.5

* Cable 3 m H07RN-F is included.

WATER, DRAIN AND VENTILATION CONNECTIONS	WD-7 GLASS
Water quality, hardness (°dH)	2 - 7
Water connection 5-65°C (external thread)	R ½"
Drain connection, PP pipe (ø mm.)	50
Water capacity, min/max pressure (kPa)	180
Water capacity, flow (litres/min)	18
Water capacity hood lift, pressure (kPa)	300
Floor drain, capacity (litres/sec)	3
Heat load to the room (total, sensible, latent) (kW)	2.3/1.7/0.6
For machines with the option ECO-FLOW: heat load to the room (total, sensible, latent) (kW)	1.2 / 0.9 / 0.3

SIZE AND WEIGHT FOR TRANSPORTATION	WD-7 GLASS
Size, LxWxH (mm.) *	765x805x1650
Weight (kg) *	125

* Packaging included

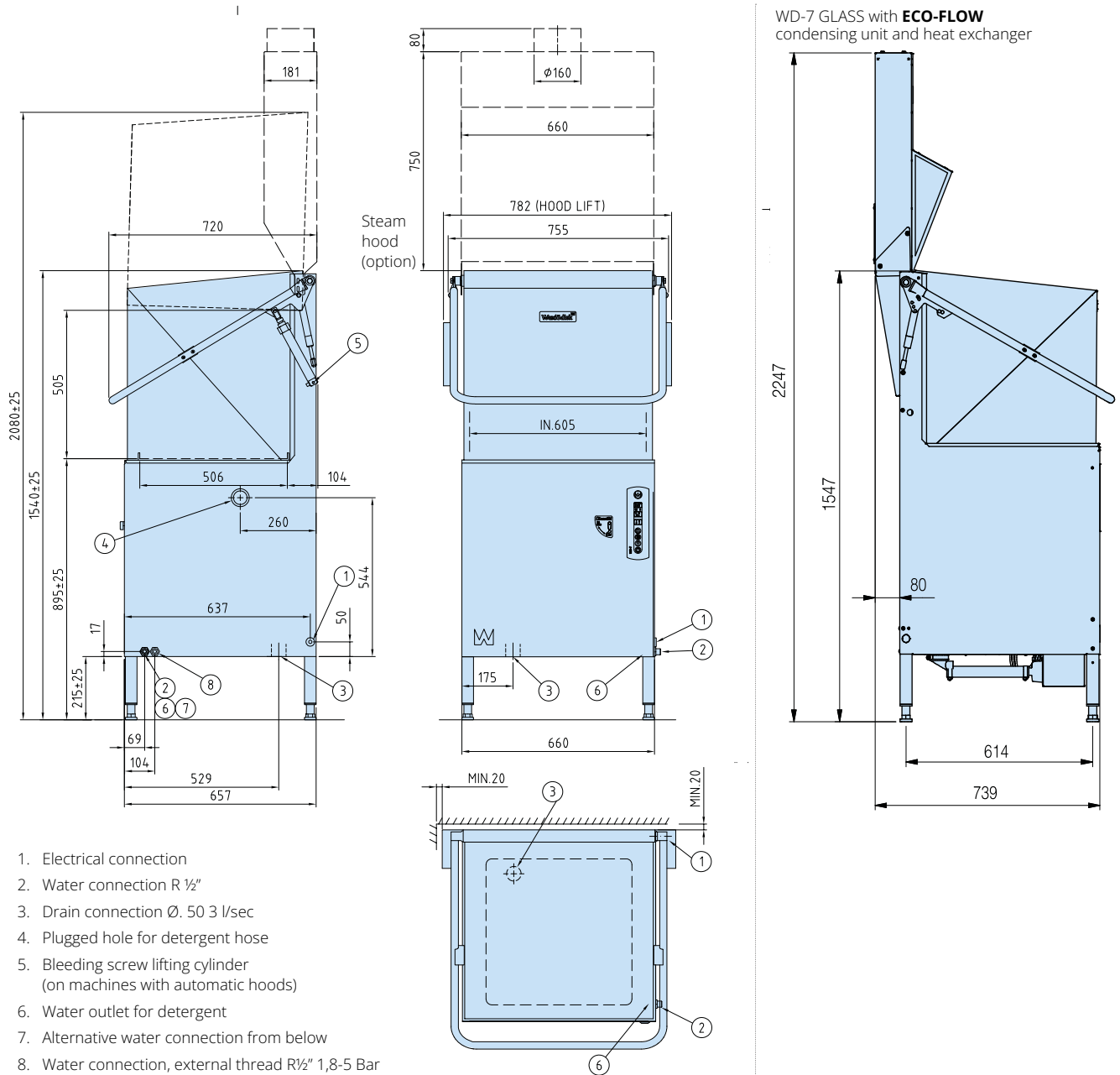

We reserve the right to change technical data.



WD-7 DUPLUS GLASS

HOOD TYPE DISHWASHER

FEATURES

- The unique Glasstilt prevents water from accumulating on the base of the glass. Manual polishing of glass is minimized
- Double final rinse with DUPLUS technology – Improved rinsing results using less fresh water
- High efficiency with low operating costs – DUPLUS technology reduces the consumption of fresh water, chemicals and electricity
- Unique and flexible washing system. The machines water pressure can be reset quickly and easily between normal and heavily soiled settings
- Robust and reliable design in stainless steel with components that guarantee a durable and reliable operation for many years
- The machine has an energy saving heat and sound insulating double-skinned hood
- A good working environment with the unique hood concept
- Self-drained wash pump
- High levels of hygiene with an automatic cleaning programme and guaranteed rinse temperature by thermal stop system
- Large deep tank to protect against foaming
- Easy servicing - the machine is serviced from the front
- Hygiene control – control system with integrated HACCP
- Excellent wash results – with selfdraining washing arms
- Powerful washing pressure with anti-blocking nozzles
- Individual adjustable wash- and rinse times as well as temperatures for each programme
- Inbuilt dosing pump for fine dosage of rinse aid
- Break tank with booster pump
- Automatic cleaning program
- Water connection x 2 (RO)



OPTIONS

- Automatic hood
- Autostart for automatic hood
- 230V/3/50Hz
- Drain pump
- Detergent pump for liquid detergent
- ECO-FLOW condensing unit with heat recovery by the exhausted steam. (cold water connection is required)
- WEB Tool - For external HACCP documentation

EXTRA EQUIPMENT

- Steam hood with suction connection
- Shelf for chemical storage
- Sideboard (560 x 560 mm)

TECHNICAL DATA	WD-7 DUPLUS GLASS
Wash pump (kW)	1.1
Pump, recirculated rinse (kW)	0.67
Pump, final rinse (kW)	0.67
Booster heater (kW)	9
Tank heater (kW)	5.4
Tank volume, chemical wash tank (liter)	45
Tank volume, recirculated rinse (liter)	5.5
Weight, machine in operation (kg)	195
Enclosure class (IP)	45

CAPACITY AND OPERATING DATA	WD-7 DUPLUS GLASS
Total washing time P1 (min) *	1.2
Total washing time P2 (min) *	1.8
Total washing time P3 (min) *	3.3
Max. capacity, baskets/hour (no.)	50
Water consumption rinsing/programme (liter)	1.0 - 1.5
Energy consumption (% of connected power)	30 - 50%
Sound level (dB(A))**	63

* Factory setting. The washing time can be adjusted.

*** Measured 1 metre from the side of the machine.

CONNECTION, MACHINE	WD-7 DUPLUS GLASS
Total connected power (kW)	10.1
Main fuse 400 3N~ (A) *	16
Max. connection area 400V 3N~ (L1-L3,N,PE) Cu (mm2) **	2.5

* Other voltage on request.

** Cable 3 m H07RN-F is included.

WATER, DRAIN AND VENTILATION CONNECTIONS	WD-7 DUPLUS GLASS
Water quality, hardness (°dH)	2 - 7
Water connection 5-65°C (external thread)*	R ½"
Drain connection, PP pipe (ø mm.)	50
Water capacity, pressure (kPa)	20
Water capacity, flow (litres/min)	5
Floor drain, capacity (litres/sec)	3
Heat load to the room (total, sensible, latent) (kW)	1.7 / 1.2 / 0.5
For machines with the option ECO-FLOW: heat load to the room (total, sensible, latent) (kW)	0.9 / 0.6 / 0.3

* When using cold water <55°C the filling time is longer.

SIZE AND WEIGHT FOR TRANSPORTATION	WD-7 DUPLUS GLASS
Size, LxWxH (mm.)*	765x805x1650
Weight (kg)*	160

* Packaging included

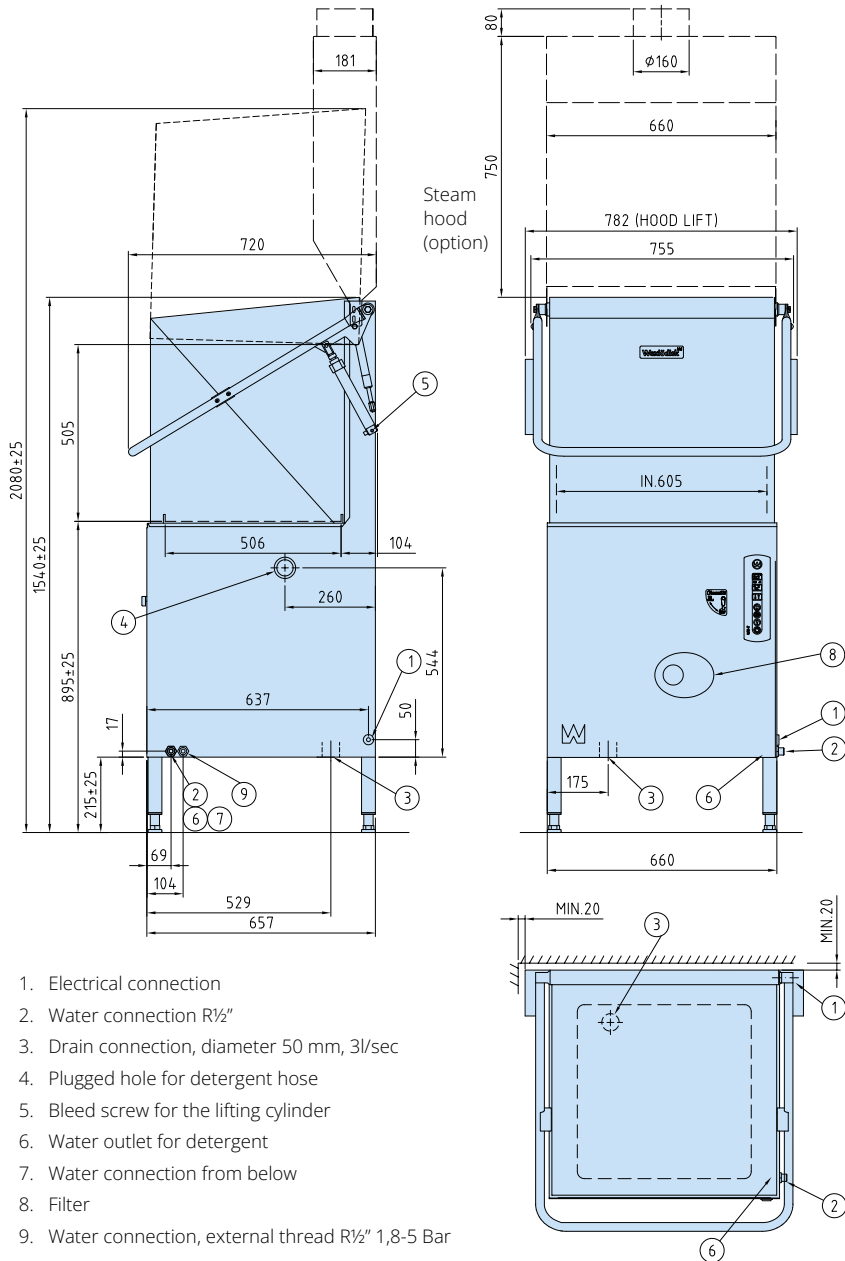

WD-7 DUPLUS GLASS with **ECO-FLOW** condensing unit and heat exchanger

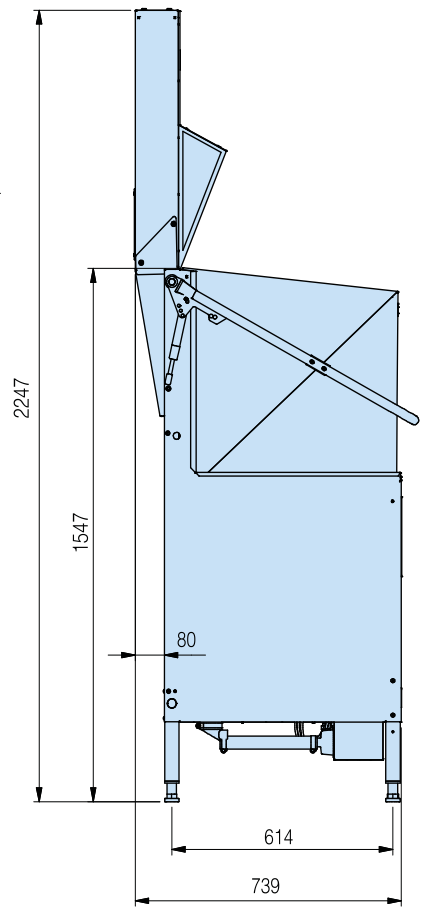

We reserve the right to change technical data.

По вопросам продаж и поддержки обращайтесь:

Алматы (727)345-47-04
Ангарск (3955)60-70-56
Архангельск (8182)63-90-72
Астрахань (8512)99-46-04
Барнаул (3852)73-04-60
Белгород (4722)40-23-64
Благовещенск (4162)22-76-07
Брянск (4832)59-03-52
Владивосток (423)249-28-31
Владикавказ (8672)28-90-48
Владимир (4922)49-43-18
Волгоград (844)278-03-48
Вологда (8172)26-41-59
Воронеж (473)204-51-73
Екатеринбург (343)384-55-89

Иваново (4932)77-34-06
Ижевск (3412)26-03-58
Иркутск (395)279-98-46
Казань (843)206-01-48
Калининград (4012)72-03-81
Калуга (4842)92-23-67
Кемерово (3842)65-04-62
Киров (8332)68-02-04
Коломна (4966)23-41-49
Кострома (4942)77-07-48
Краснодар (861)203-40-90
Красноярск (391)204-63-61
Курск (4712)77-13-04
Курган (3522)50-90-47
Липецк (4742)52-20-81

Магнитогорск (3519)55-03-13
Москва (495)268-04-70
Мурманск (8152)59-64-93
Набережные Челны (8552)20-53-41
Нижний Новгород (831)429-08-12
Новокузнецк (3843)20-46-81
Ноябрьск (3496)41-32-12
Новосибирск (383)227-86-73
Омск (3812)21-46-40
Орел (4862)44-53-42
Оренбург (3532)37-68-04
Пенза (8412)22-31-16
Петрозаводск (8142)55-98-37
Псков (8112)59-10-37
Пермь (342)205-81-47

Ростов-на-Дону (863)308-18-15
Рязань (4912)46-61-64
Самара (846)206-03-16
Санкт-Петербург (812)309-46-40
Саратов (845)249-38-78
Севастополь (8692)22-31-93
Саранск (8342)22-96-24
Симферополь (3652)67-13-56
Смоленск (4812)29-41-54
Сочи (862)225-72-31
Ставрополь (8652)20-65-13
Сургут (3462)77-98-35
Сыктывкар (8212)25-95-17
Тамбов (4752)50-40-97
Тверь (4822)63-31-35

Тольятти (8482)63-91-07
Томск (3822)98-41-53
Тула (4872)33-79-87
Тюмень (3452)66-21-18
Ульяновск (8422)24-23-59
Улан-Удэ (3012)59-97-51
Уфа (347)229-48-12
Хабаровск (4212)92-98-04
Чебоксары (8352)28-53-07
Челябинск (351)202-03-61
Череповец (8202)49-02-64
Чита (3022)38-34-83
Якутск (4112)23-90-97
Ярославль (4852)69-52-93

Россия +7(495)268-04-70

Казахстан +7(727)345-47-04

Беларусь +(375)257-127-884

Узбекистан +998(71)205-18-59

Киргизия +996(312)96-26-47

эл.почта: wkd@nt-rt.ru || сайт: <https://wexiodisk.nt-rt.ru/>